

Modellname: **MORANO**
 Nazwa modelu:

Modellreihe: **WW103T08** Type: **08**
 Numer modelu: Typ:

Blatt Nr **1** von: **3**
 Strona z:

MONTAGEANLEITUNG INSTRUKCJA MONTAŻOWA

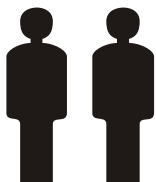
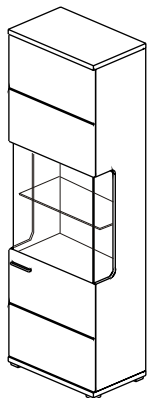

2 Personen
2 Osoby

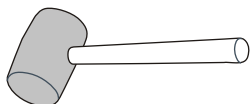
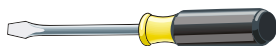
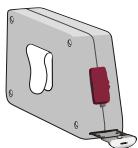

Pflegehinweis!

Bitte nur mit einem Staubtuch oder einem feuchten Lappen reinigen.
KEINE scheuernde Putzmittel verwenden !

Wskazówka dotycząca pielęgnacji!

Proszę czyścić tylko suchą lub lekko wilgotną szmatką do kurzu.
 Nie używać żadnych środków szorstkich !

Max. zulässige Belastungen von Einlegeböden in kg:

Maksymalne obciążenie półek w kg:

Stärke/Gr. Länge/Dł. mm	Spanplatte/Płyta			Glas/Szkło 5/6
	15	18	22	
0<400				Länge bis
401<600	40	40	40	600 mm/15kg
601<800	24			Länge bis
801<1000	15	30		900 mm/10kg

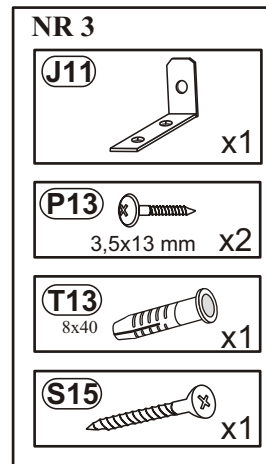
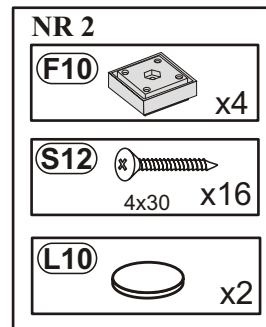
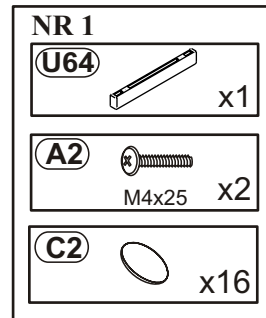
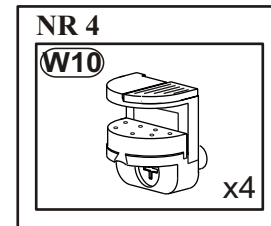
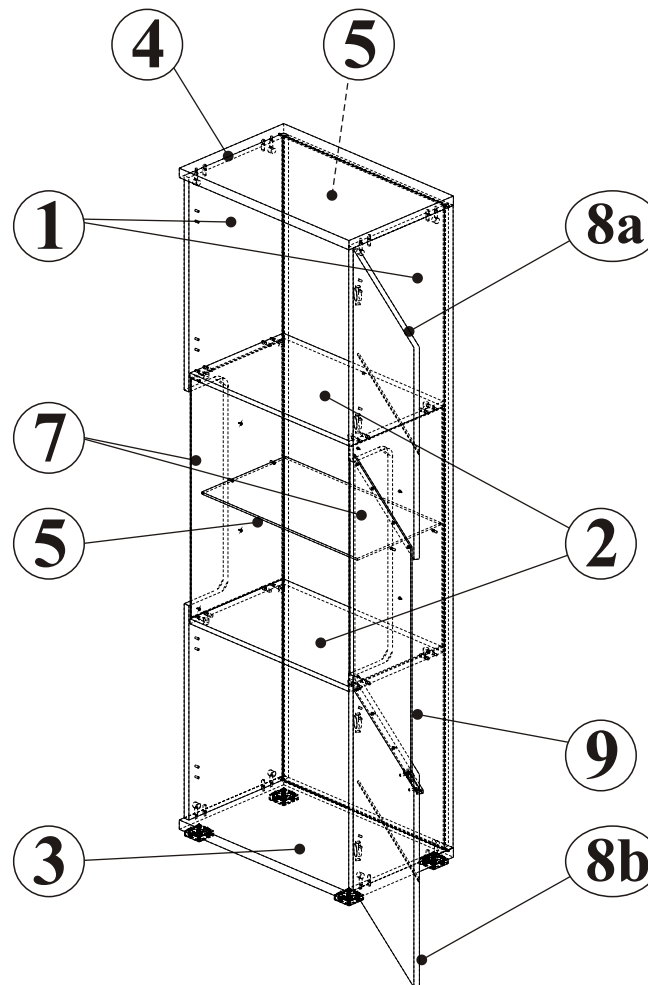

1

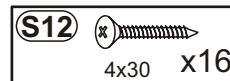
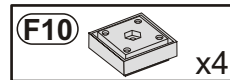
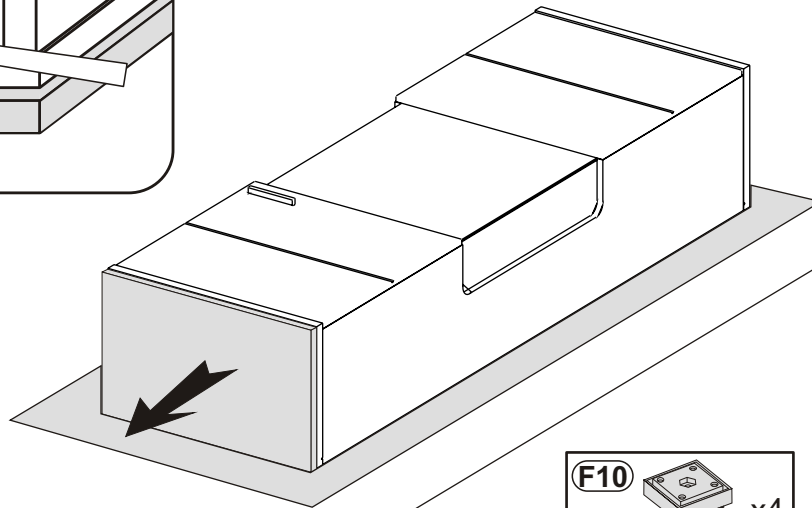
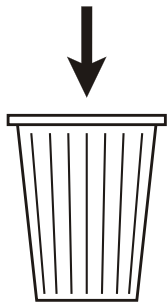
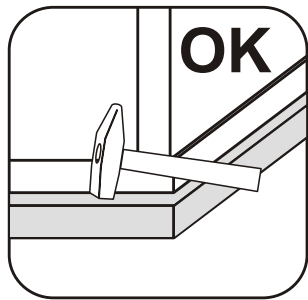

2

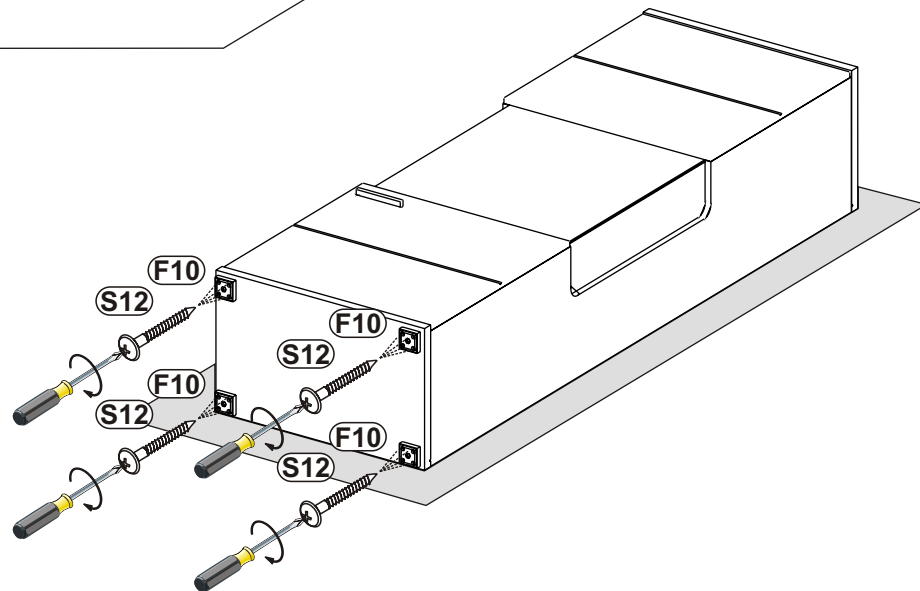

3

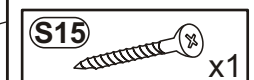
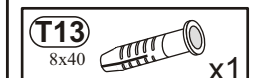
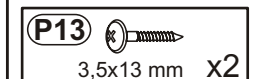
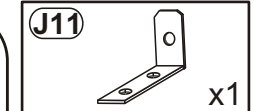
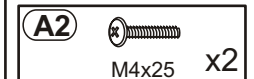
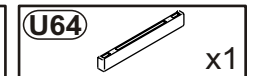
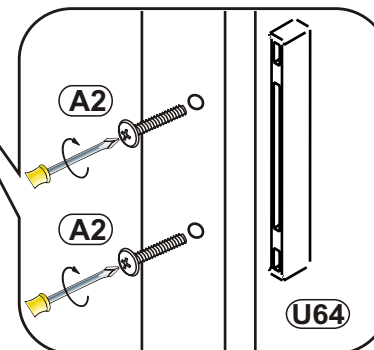
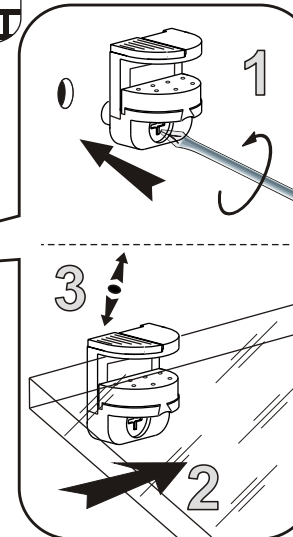
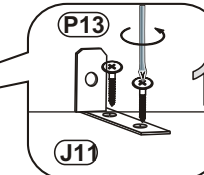
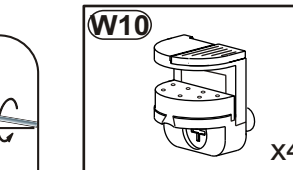
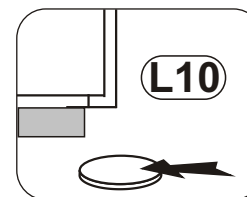
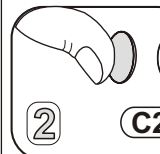
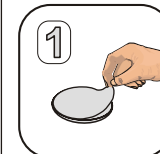
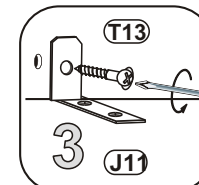
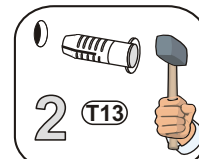

Achtung !
 Bei Bedarf greifen Sie auf
 das Unterlegmaterial zurück.

